



WELCOME TO UC RIVERSIDE

SCHOOL of MEDICINE EDUCATION BUILDING II

Community Meeting

October 14, 2020

6 p.m. – 7 p.m.



AGENDA

- Introductions
- Project Overview
 - Project Mission and Goals
 - Site Location
 - Project Program
 - Anticipated Schedule
- Questions and Answers

INTRODUCTIONS

Jacqueline Norman, Campus Architect

Blythe Wilson, Director of Project Management

Melissa Garrety, Campus Planner

Mihai Gavan, Project Manager

Stephanie Tang, Campus Environmental Planner

Jaime Engbrecht, Campus Planner

Jeff Kraus, Community & Local Government Relations

PROJECT OVERVIEW



SCHOOL OF MEDICINE MISSION AND VALUES

The School of Medicine Mission

“Improve the health of the people of California and, especially, to serve Inland Southern California by training a diverse workforce of physicians and by developing innovative research and health care delivery programs that will improve the health of the medically underserved in the region and become models to be emulated throughout the state and nation.”

and Values

Inclusion – Embracing diversity in the broadest sense and appreciating all points of view

Integrity – Exhibiting honesty and the highest ethical standards in all matters

Innovation – Pursuing organizational goals with creativity and novelty

Excellence – Demonstrating extraordinary dedication to the highest quality outcomes

Accountability – Taking responsibility and ownership

Respect – Showing consideration and appreciation for others

PROJECT MISSION AND GOALS

The School of Medicine Education Building II

- Will provide adequate space for the School of Medicine MD Program to grow to a class size of 125, and a total student population of 500
- Will create a “home base” that is welcoming to not only faculty, students, and staff, but also to the community
- Will facilitate interaction, help build synergies and partnerships, and support student success
- Will provide flexibility for the future needs and growth of the School of Medicine by providing appropriate spatial configurations and adaptability
- Will create a central core of School of Medicine facilities by connecting the new ED2 building to the existing ED1 facility and future spaces reconfigured within neighboring Orbach Library
- Will bring people together, cross boundaries and increase the health and well-being of people in Southern California

SITE LOCATION-PROJECT LOCATION MAP



SITE LOCATION-PROJECT SITE

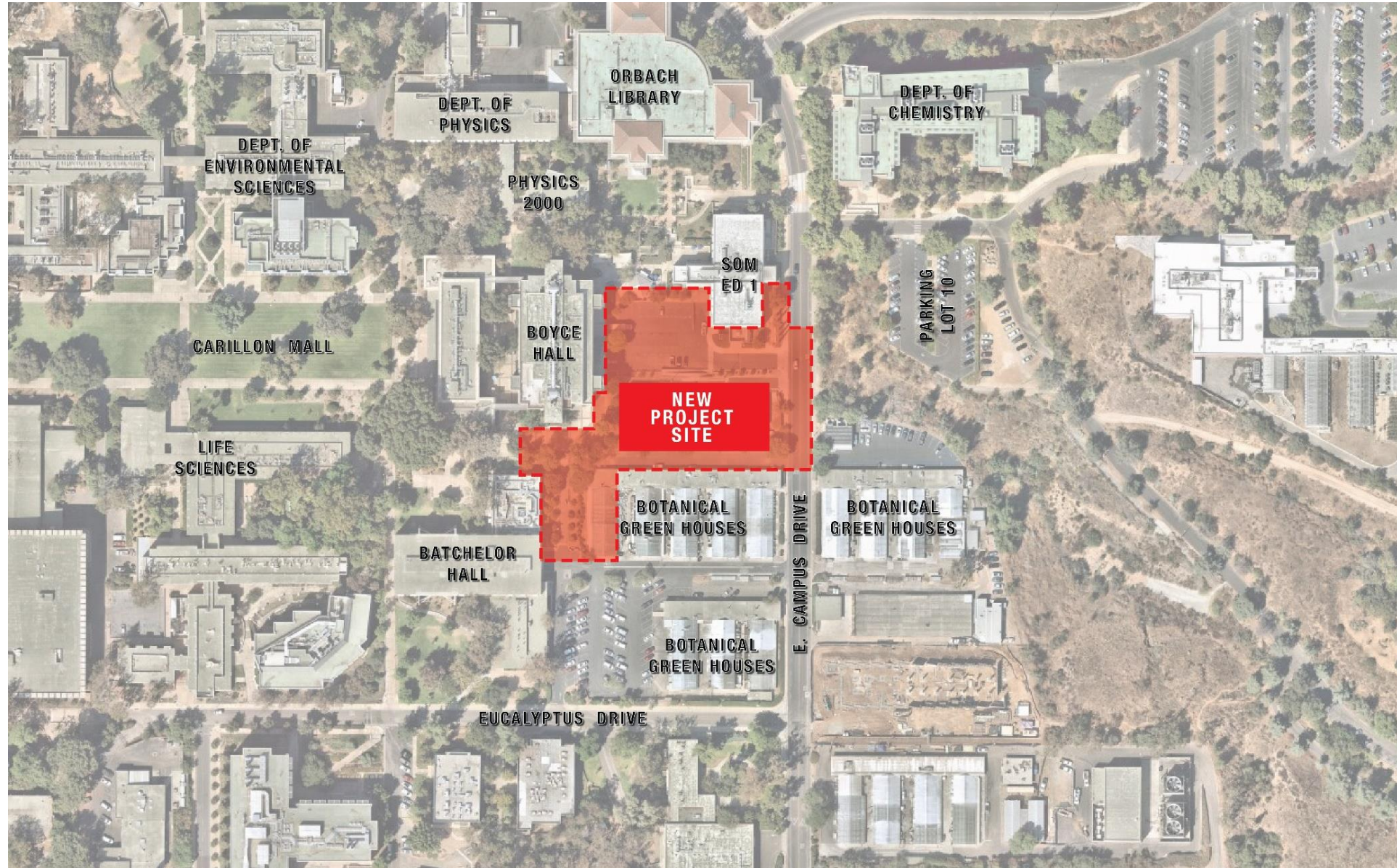

SITE LOCATION-PROJECT SITE

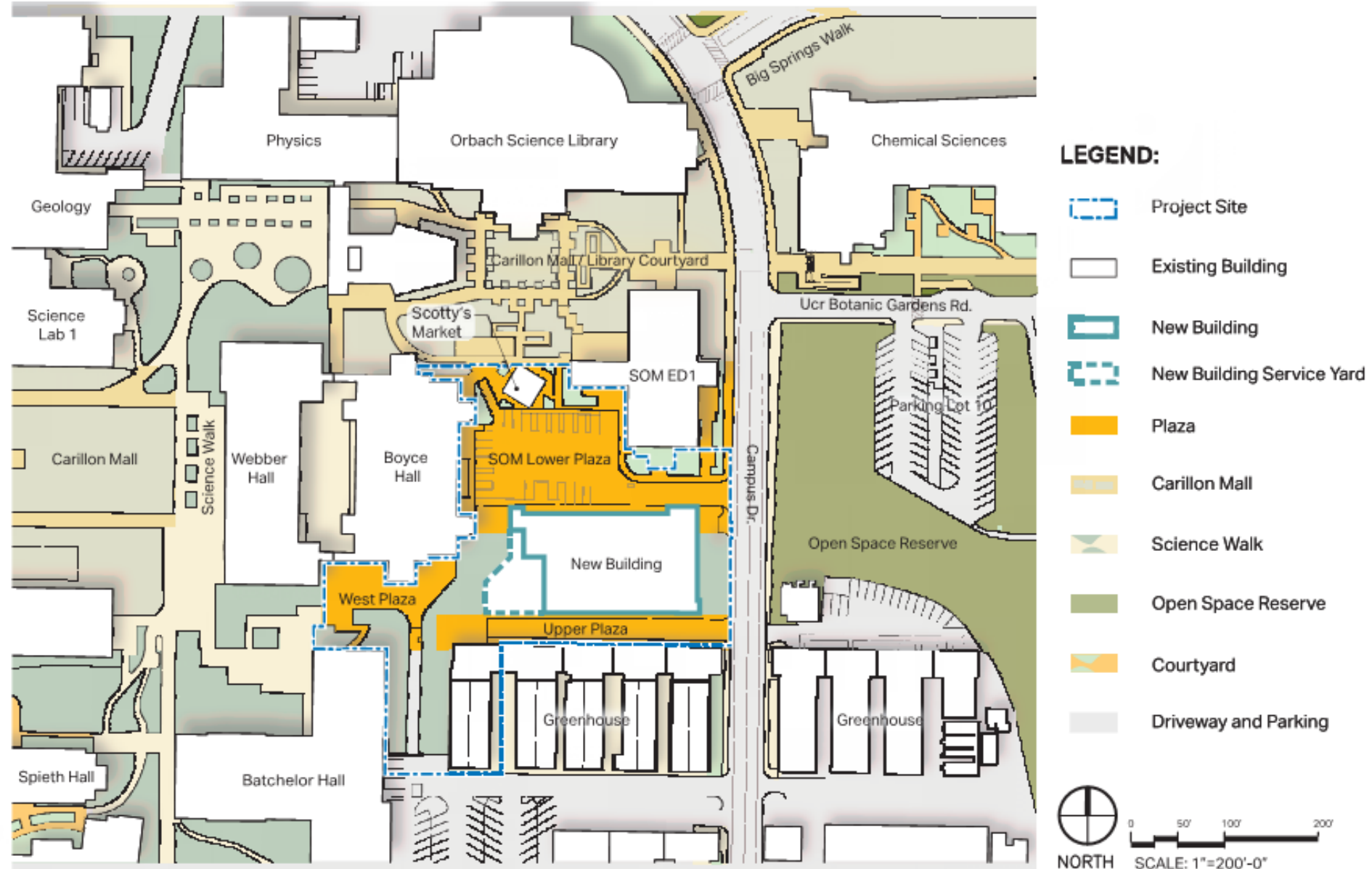

PROJECT PROGRAM

1.0 Instructional

Large Group Learning- Flat and Tiered/ Support
Active Learning Classroom/ Support
Problem Based Learning Rooms

Anticipated GSF: Up to 120,000 SQFT



PROJECT PROGRAM

1.0 Instructional

Large Group Learning- Flat and Tiered/ Support
Active Learning Classroom/ Support
Problem Based Learning Rooms

ROOM DATA

- 1.0 Instructional & Teaching Labs
- 1.11 Flat Floor Flexible - Large Group Learning

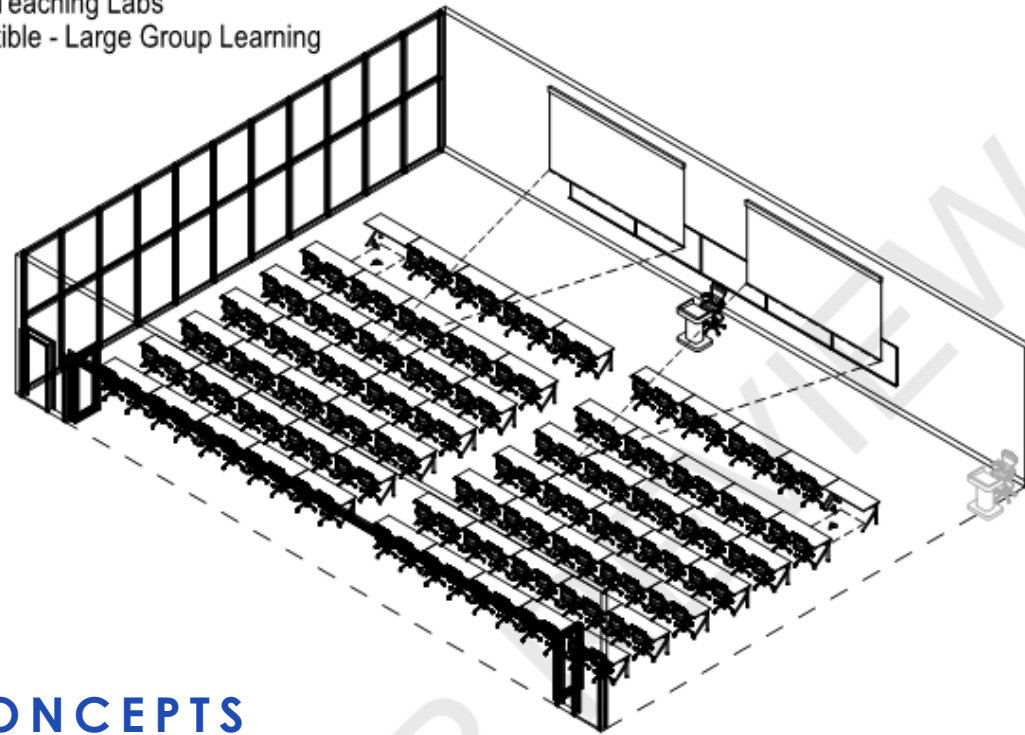

ROOM DATA

- 1.0 Instructional & Teaching Labs
- 1.12 Tiered Floor - Large Group Learning

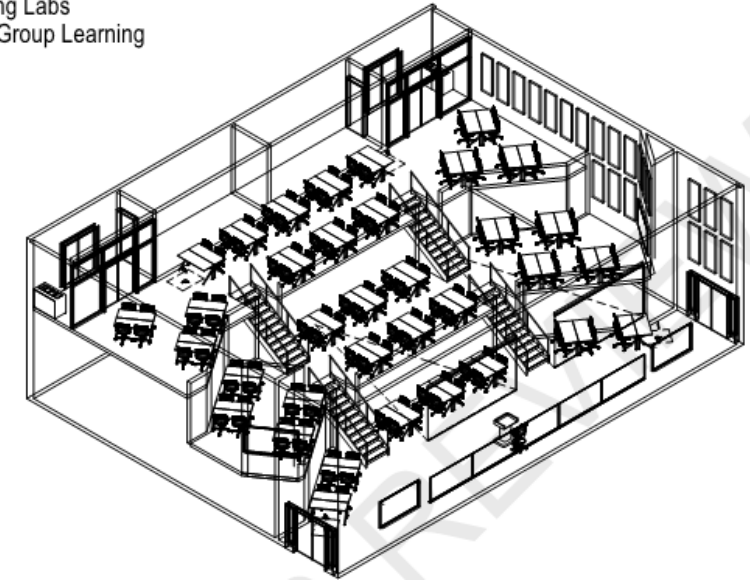

ROOM DATA

- 1.0 Instructional & Teaching Labs
- 1.12 Tiered Floor - Large Group Learning

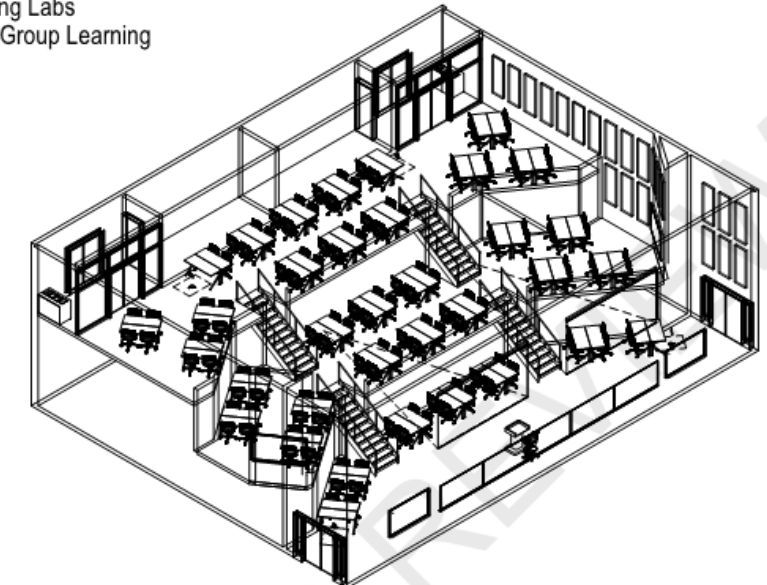

ROOM CONCEPTS

PROJECT PROGRAM

2.0 Office and Support

- Enclosed Offices
- Work Stations
- Support Rooms
- Conference Rooms
- Staff Lounge Spaces

Anticipated GSF: Up to 120,000 SQFT



PROJECT PROGRAM

2.0 Office and Support

- Enclosed Offices
- Work Stations
- Support Rooms
- Conference Rooms
- Staff Lounge Spaces

ROOM DATA

- 2.1 Offices & Work Stations
- 2.12 - Enclosed Office - Standard

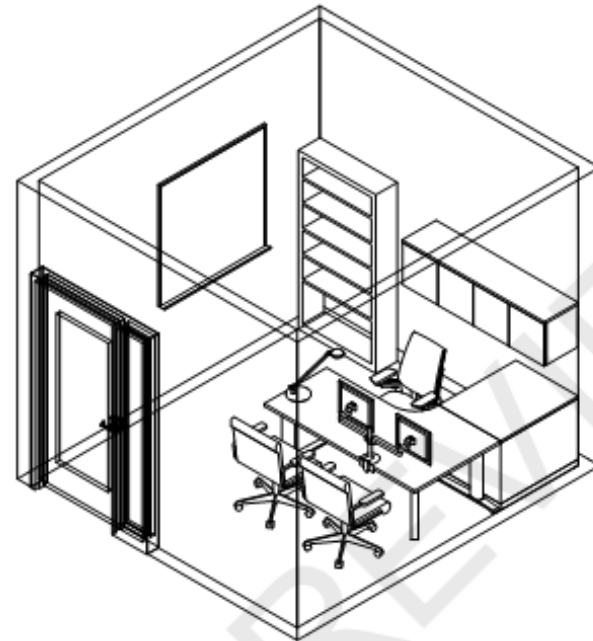

ROOM DATA

- 2.1 Offices & Work Stations
- 2.13 / 2.14 - Hoteling/Open Work Station

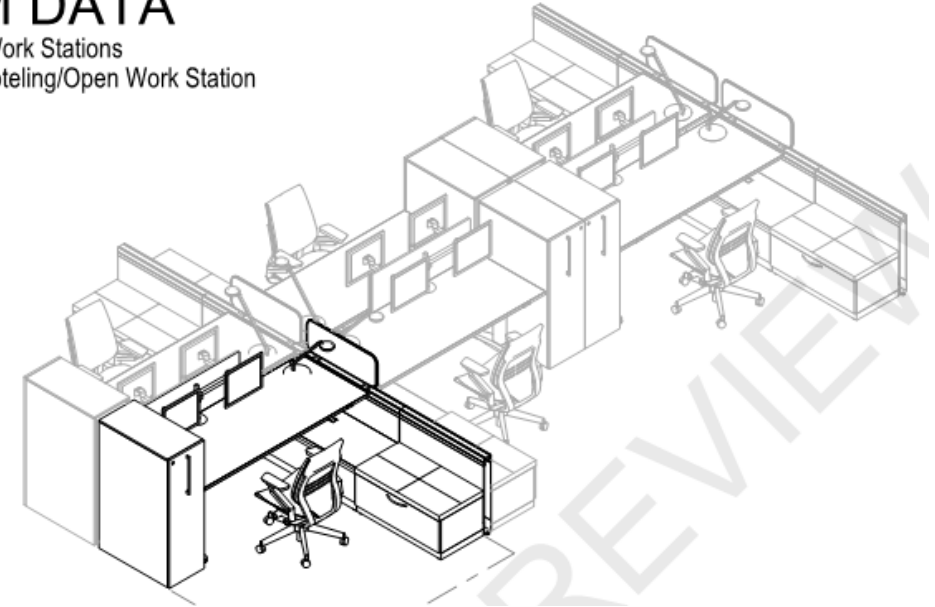

ROOM DATA

- 2.3 Office Shared Collaboration
- 2.32 Conference Rooms - 10 seats

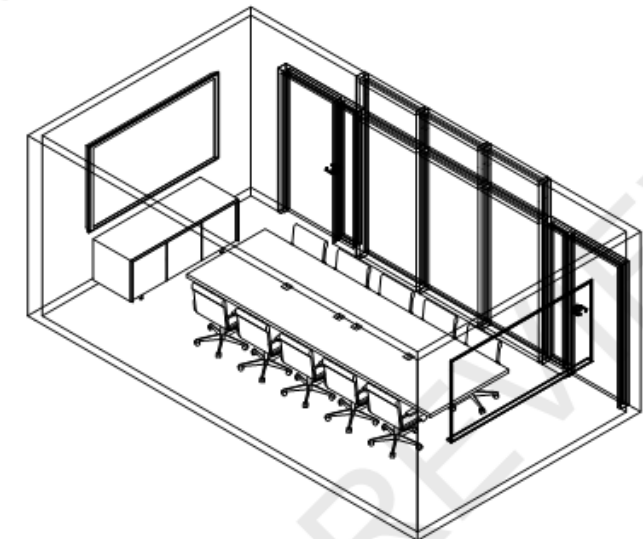

ROOM CONCEPTS

PROJECT PROGRAM

Anticipated GSF: Up to 120,000 SQFT

3.0 Collaboration and Student Life

- Lobby/ Reception
- Meditation Room
- Student Lounge Spaces
- Meeting Rooms
- Study Rooms
- Open Study



PROJECT PROGRAM

3.0 Collaboration and Student Life

- Lobby/ Reception
- Meditation Room
- Student Lounge Spaces
- Meeting Rooms
- Study Rooms
- Open Study

ROOM DATA

- 3.2 Shared Collaboration
- 3.21 Meeting Room - Large

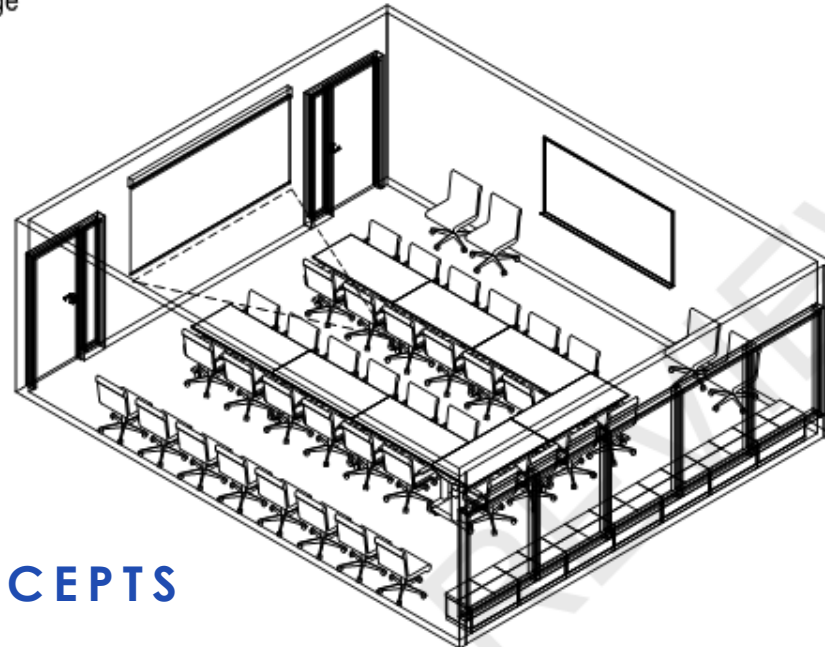

ROOM CONCEPTS

ROOM DATA

- 3.1 Shared Amenities
- 3.13 - Lounge - Large Student

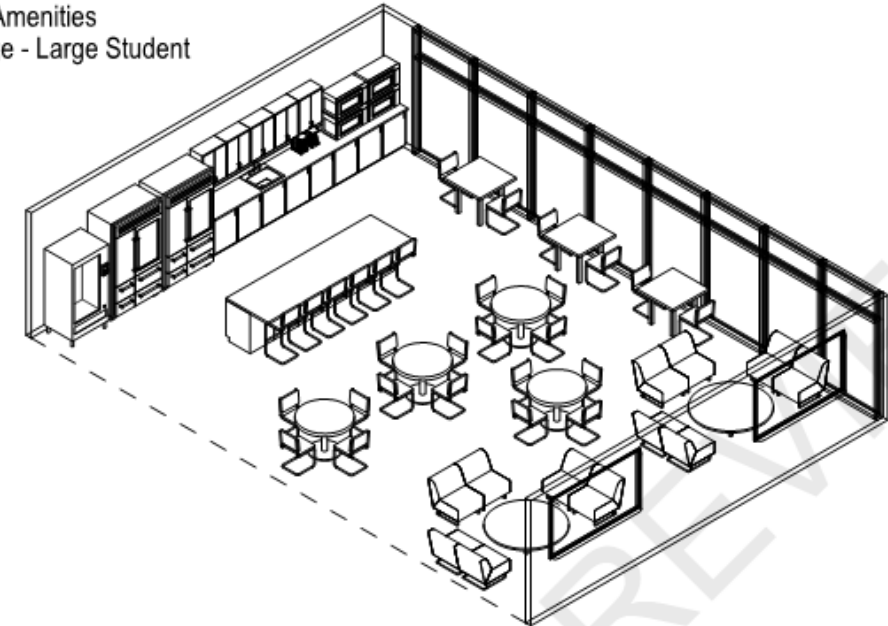

ROOM DATA

- 3.3 Study Space
- 3.31 Study Room - Large

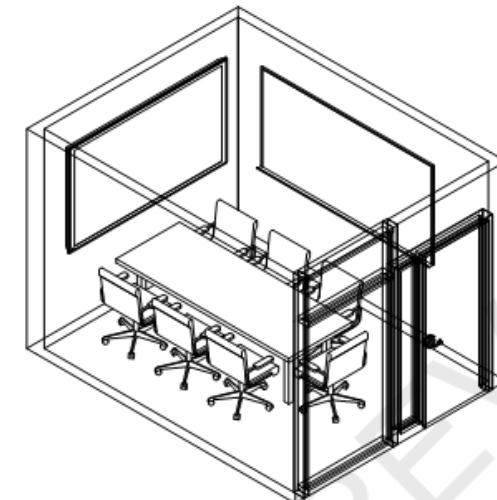

PROJECT PROGRAM

MASSING CONCEPTS

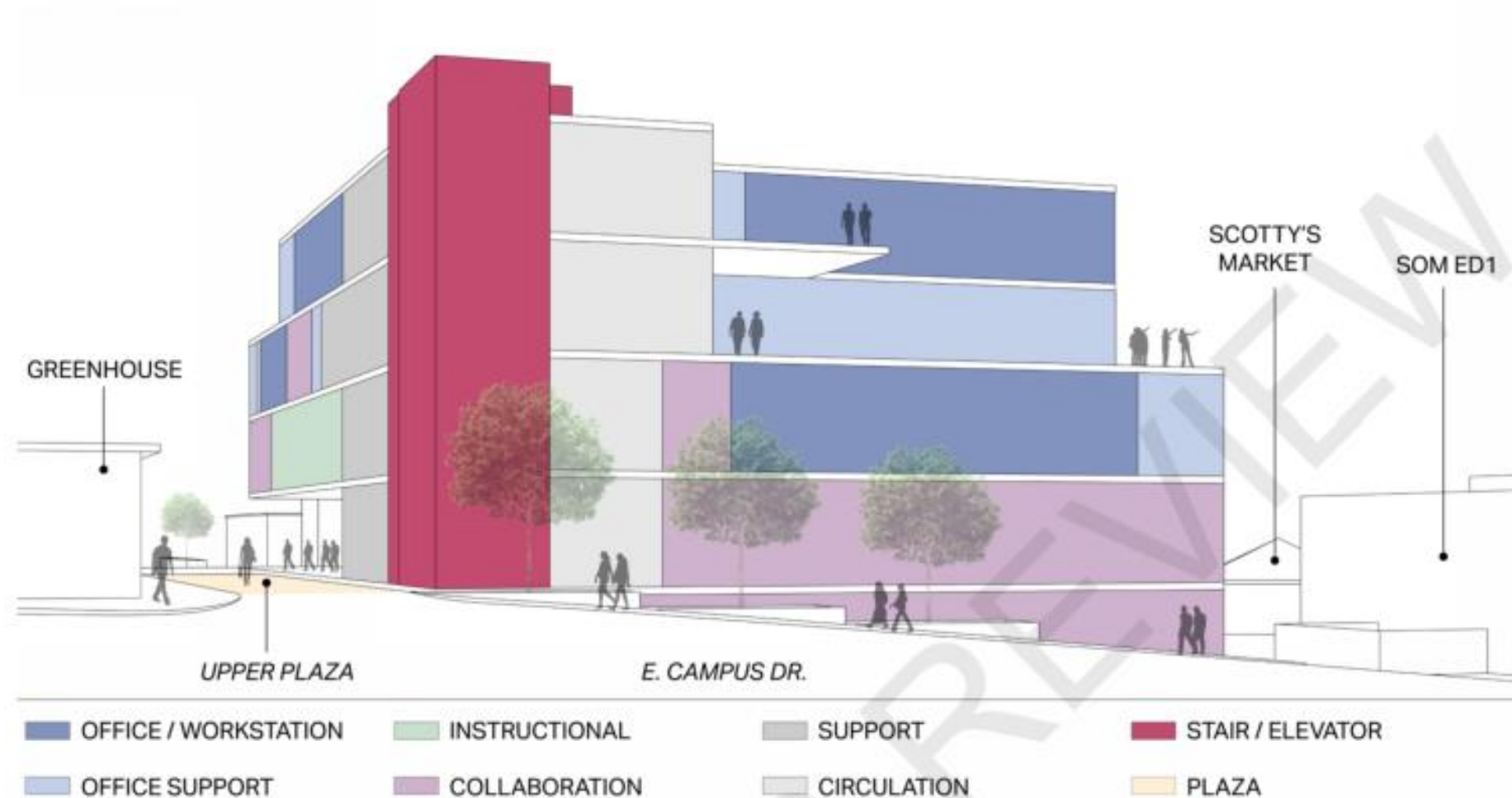

CONCEPTUAL MASSING/PROGRAM STACK FROM SOUTHEAST CORNER

PROJECT PROGRAM

MASSING CONCEPTS

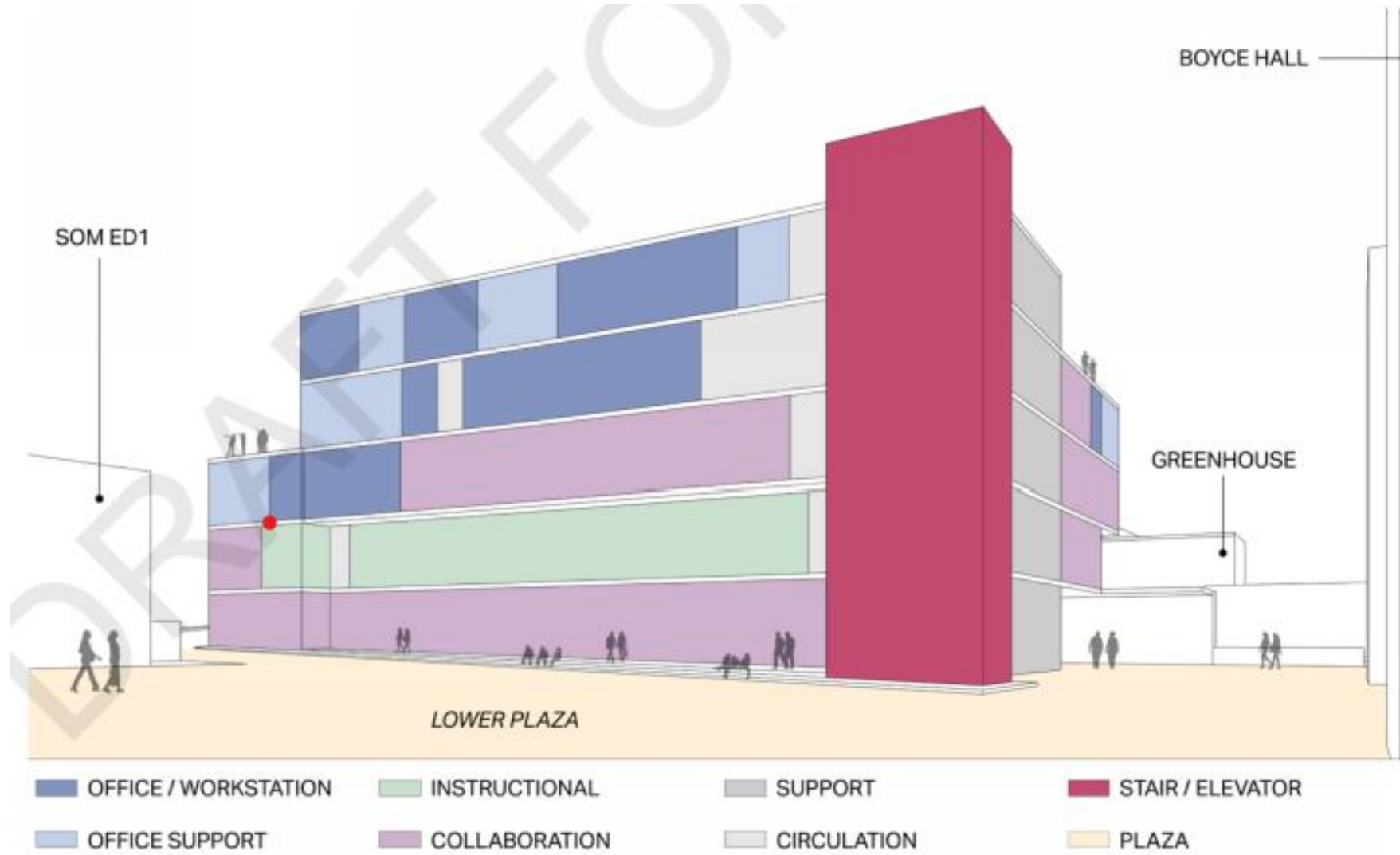

CONCEPTUAL MASSING/PROGRAM STACK FROM NORTHWEST CORNER

PROJECT PROGRAM

MASSING CONCEPTS

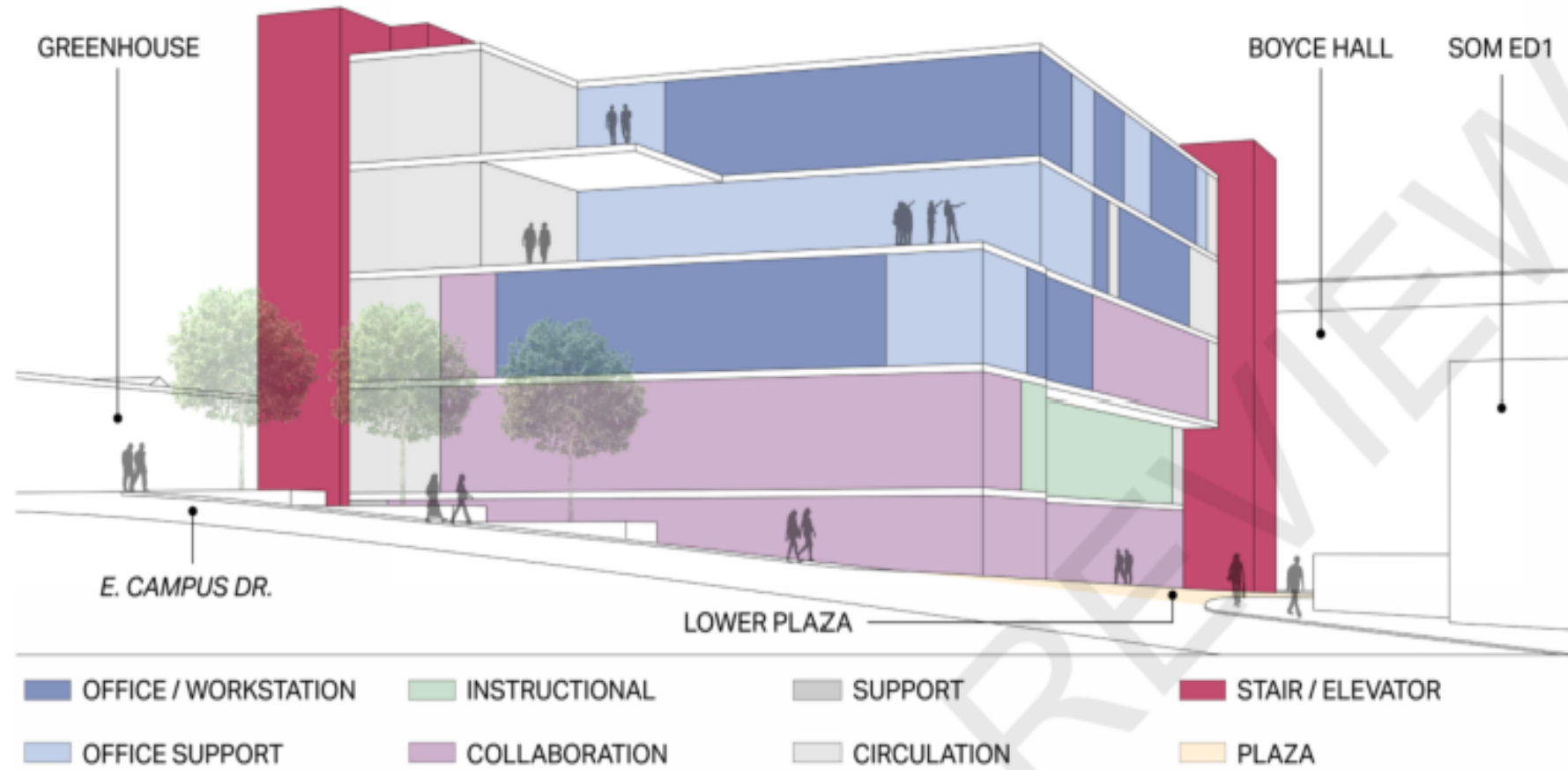

CONCEPTUAL MASSING/PROGRAM STACK FROM NORTHEAST CORNER

PROJECT PROGRAM

MASSING CONCEPTS

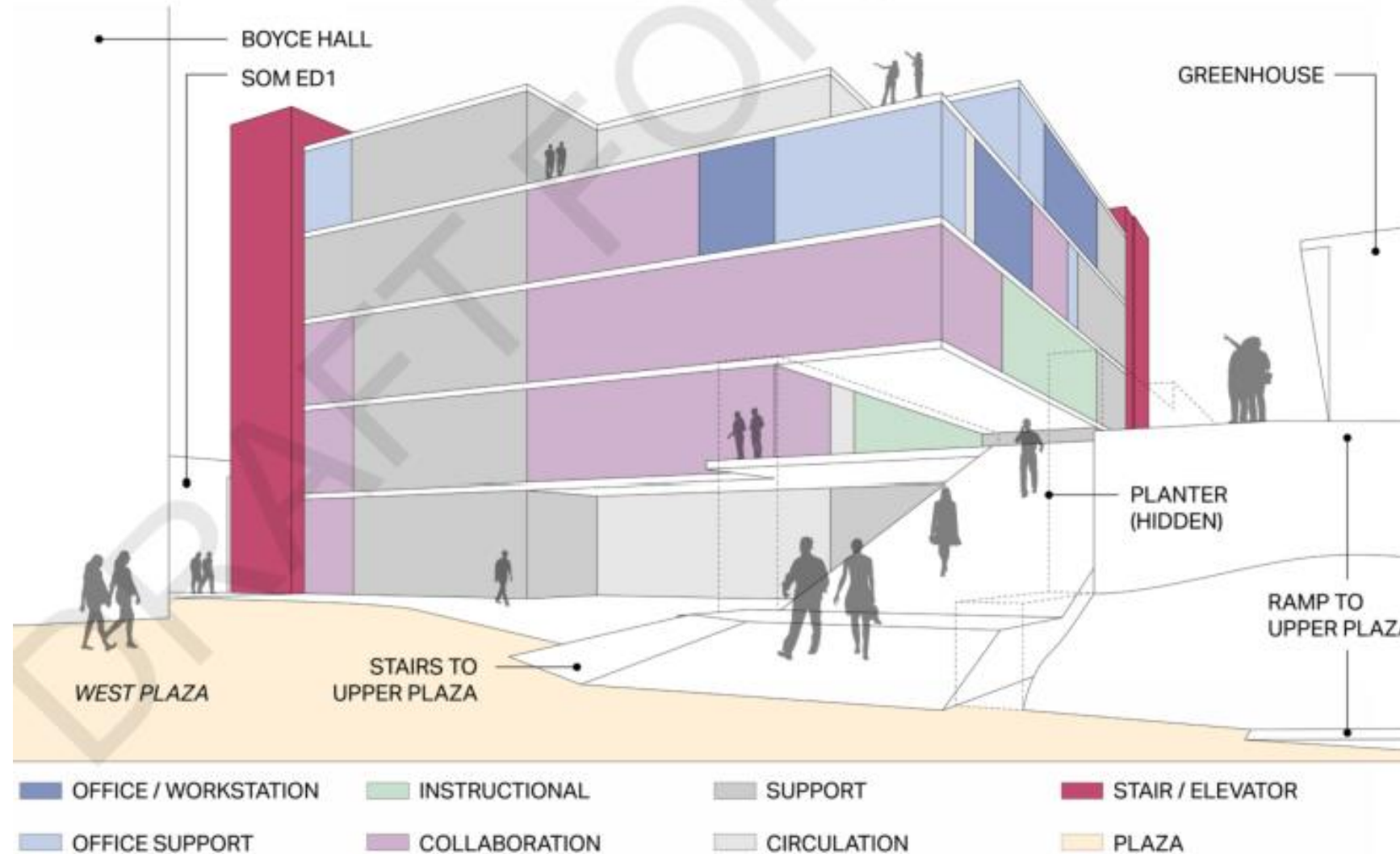

CONCEPTUAL MASSING/PROGRAM STACK FROM SOUTHWEST CORNER

ANTICIPATED SCHEDULE

Delivery Method: DESIGN BUILD

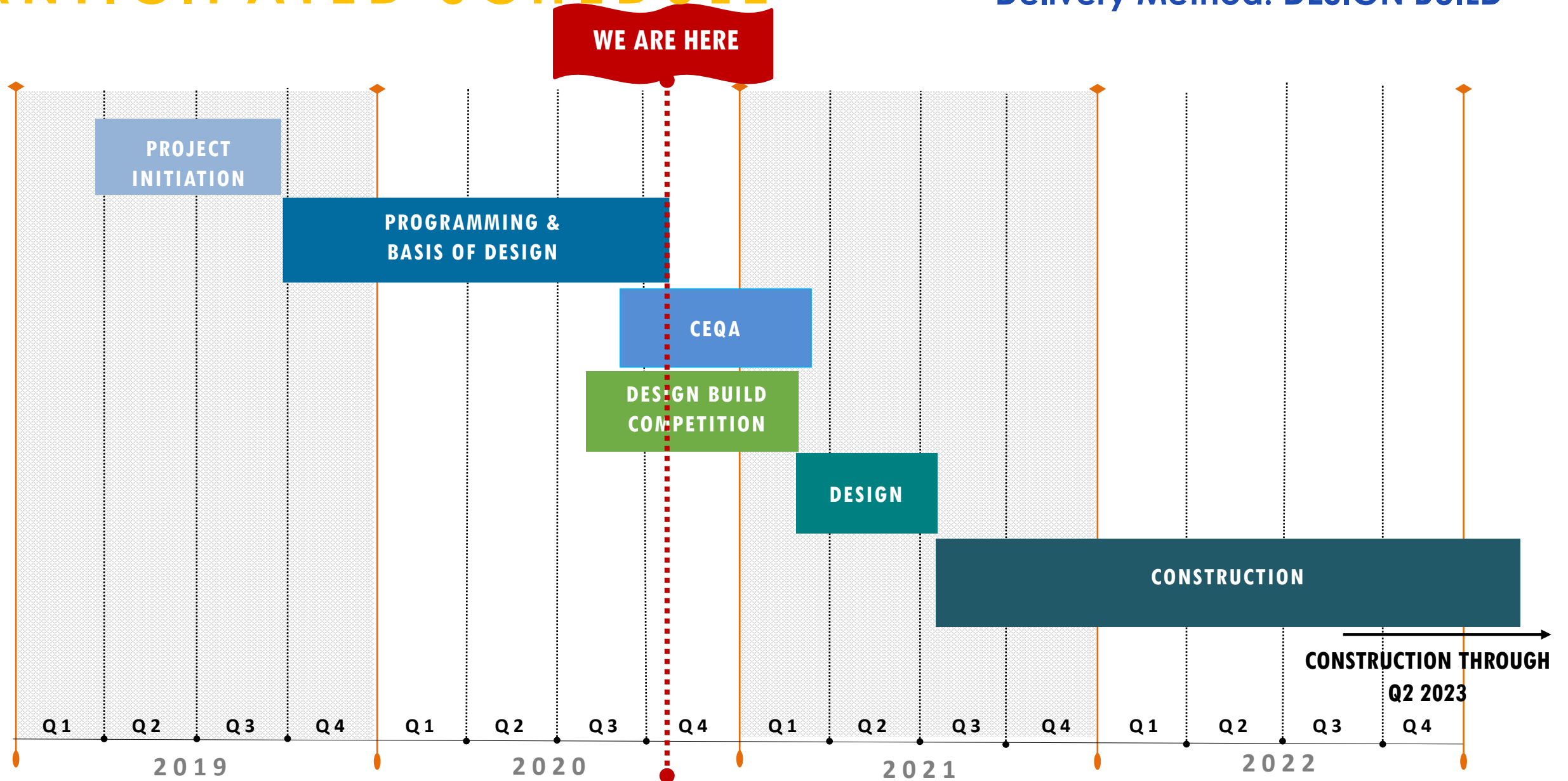

QUESTIONS AND ANSWERS



QUESTIONS AND ANSWERS

- **Please provide additional written comments no later than September 9, 2020 to:**

UC Riverside
Planning, Design & Construction
Jaime Engbrecht, Campus Planner
1223 University Village, Suite 240
Riverside, CA 92507

Email: planning@ucr.edu

- **Please include Commenter's name, address, phone number and email address.**

Written responses to comments will be provided at:

<https://pdc.ucr.edu/environmental-planning-ceqa>

Thank you